

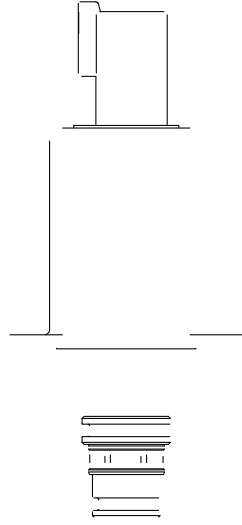

01



	0.235Kg
MTTF <sub>d</sub>	150
	-30-80

	P <sub>p</sub> = 60bar
	P <sub>r</sub> = 30bar
	NAS1638 9      ISO4406 20/18/15
	DIN 51524
	-30-105
	< 100mL/min
	< 100mL/min
	14Qµm P

	24 V
20	34
	DT04-2P Deutsch
	IP6K6/IPX9K
	<40ms
	<40ms

HLP46 T=50

01

P A

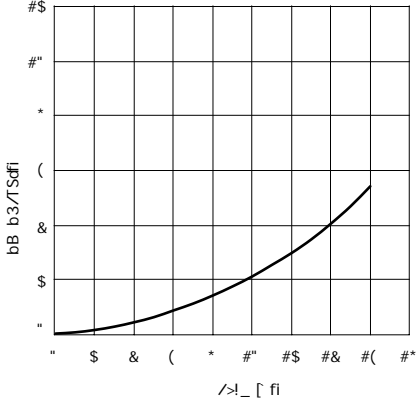

A T

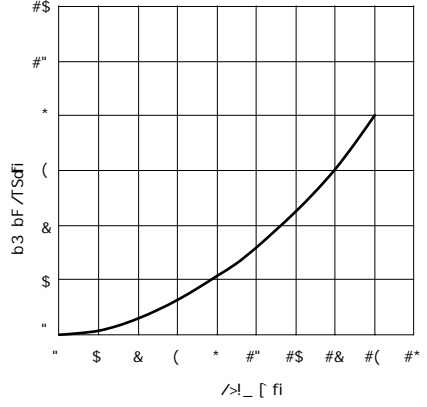

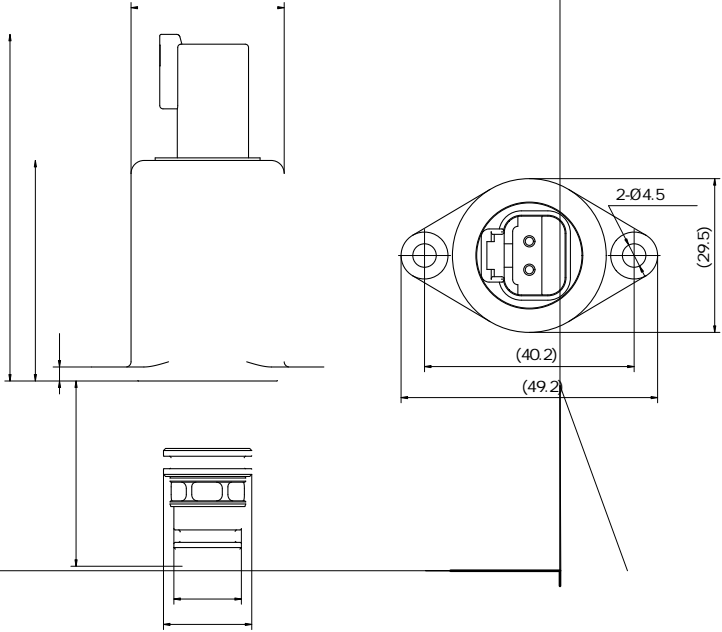

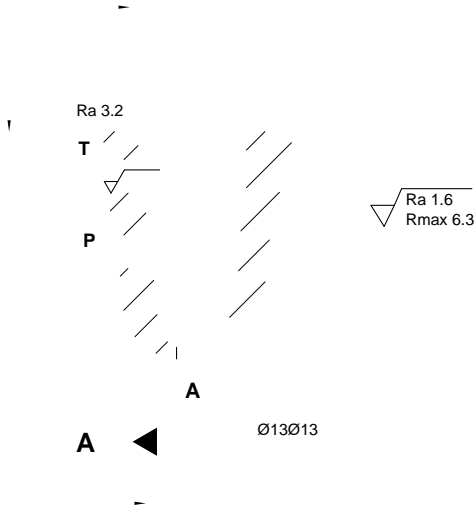

# 2

2.1	HLTS58-20	079-084
2.2	HLTS58-21F	085-090
2.3	PPRV-04	091-096
2.4	PPRV-05	097-102

